

## CLF12577NIT-D Series

### Automotive Grade Wound Ferrite Power Inductors

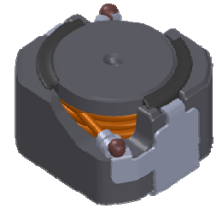

TDK's newly developed CLF-NI-D series power inductors are magnetically shielded, wire wound inductors with a magnetic ferrite core, designed for use in automotive applications. This series features a robust high-reliability design with highly heat-resistant wire and wire connections, resulting from the use of welding material that does not melt during the reflow process. A fully automated manufacturing process also ensures that all finished CLF-NI-D products are of uniform high quality. CLF-NI-D series power inductors are available in a variety of case sizes and inductance values and are AEC-Q200 compliant, meaning they can be used in a wide temperature range and in extreme environments such as the automotive engine bay.

#### Features

- Robust design—Generic use for Automotive applications
- High magnetic shield construction features low EMI
- Wide inductance range—1.0 $\mu$ H-470 $\mu$ H, E-6 Series lineup
- Operating temperature and storage temperature range of  $-55^{\circ}$ C to  $+150^{\circ}$ C (including self temperature rise)

Power

Wire wound

AEC-Q200



#### Applications

- ECM/ECU
- SRS Air bag
- Head light module
- Transmission control
- Power steering control
- ADAS etc.

[Datasheet Link](#)

## CLF12577NIT-D Series Automotive Power Inductors

<b>Case Size:</b>	12.8x12.5x7.7mm
<b>Inductance Range:</b>	1.0uH-6.8uH +/- 30%, 10uH-470uH+/- 20%
<b>Isat*:</b>	1.0-22.0A
<b>Itemp*:</b>	1.1-11.5A
<b>DC Resistance:</b>	4.8-708m $\Omega$ max.

\*Isat : Depends on Inductance Saturation. (-30% Reduction from Nominal L Value)

\*Itemp : Depends on Self Temperature Rise (40deg.C)

**500 pieces per reel**